

RADIATION
PRODUCTS
DESIGN INC.



WATER TRANSFER TANK WITH ELECTRIC PUMP
INSTRUCTIONAL & INFORMATION BOOKLET



CE

✉ SALES@RPDINC.COM

☎ PHONE (763) 497-2071

📠 FAX (763) 497-2295

🌐 WWW.RPDINC.COM

📍 5218 BARTHEL INDUSTRIAL DRIVE
ALBERTVILLE, MN 55313 USA



PRODUCT INFORMATION

Item #

695-230

Water Transfer Tanks

Water Transfer Tank with Electric Pump - 30 Gallon
115VAC 60Hz



DISCLAIMERS

LIABILITY

Radiation Products Design, Inc. assumes no liability for consequential damages of any kind for this material when used interchangeably with products of other manufacturers/suppliers or for any direct or indirect results and consequences of its use or misuse by the customer.

Radiation Products Design, Inc. assumes no liability or responsibility resulting from the use of cleaning agents or disinfection products.



WARNINGS AND PRECAUTIONS

This device is intended to be used for water only. Use of unintended liquids or mixtures may damage the device.

Only power this device through a Ground Fault Circuit Interrupter Connection (GFCI) power outlet. Due to risk of electric shock, dry device completely and inspect area before use.

DESCRIPTION

The Water Tank is a 30 gallon drum constructed of one piece of low density polyethylene. It has a removable slide lever lock lid and two bung openings. For mobility, the water tank sits on a polyethylene dollie with four swivel casters.

- Easy to Use
- Lightweight
- Mobile
- Remote Controlled

The electric pump is 115V VAC, 1.6 Amps, with thermal protection. To pump the water from the water phantom back into the tank, simply reverse the water connections on the pump.

Specifications

Pump:**Volts:** 115 VAC**Frequency:** 60 hz**Flow Rate:** 360 Gallons Per Hour Max.**Motor Horsepower:** 1/10 Hp**Amps - Full Load:** 1.6 A**Watts - Full Load:** 91 W**Cord Length:** 6ft (1.83m)**Max PSIG - 60Hz:** 10.8 PSI**Manual Switch****Hose Connections:** 3/4" Garden Hose Thread (GHT)



ASSEMBLY

1. Place the tank on the rolling dolly
2. Connect the red hose to the outlet of the pump and the blue hose to the inlet
3. Plug the power cable into the foot pedal power input

INSTRUCTIONS FOR USE

1. If filling a contained, remove the cap, then fill the tank with water
2. Either insert the red hose into a container to fill it with water or insert the blue hose to drain a container of water
3. Ensure the cables and connectors are completely dry
4. Plug the power cable from the foot pedal into a GFCI power outlet
5. Engage the foot pedal to power the motor pump.
6. Re-engage the foot pedal to stop the motor pump

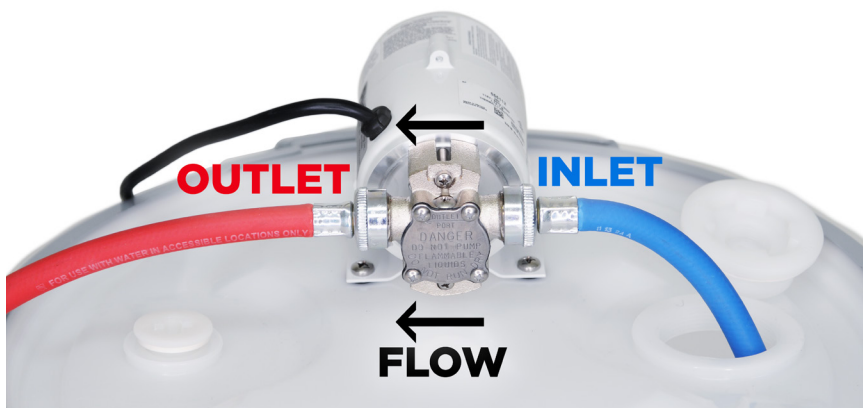

CLEANING

This device can be cleaned with regular soap and water. The top can be removed to access the tank. Hoses are also removable.

HOW TO REPLACE IMPELLER

Replace impeller when it has been worn or damaged by foreign objects., improper liquid or dry running.

1. Disconnect power before servicing motor.
2. Remove four screws (Ref. #1)
3. Remove cover plate (Ref. #2) and old gasket (Ref. #3).
4. Remove damaged or worn impeller (Ref. #4)
5. Clean the inside of the pump head and remove any foreign materials which will obstruct the impeller s operation.
6. Apply vaseline or similar lubricant to both the inside of the pump head (Ref. #5) and to the outside diameter of the impeller (Ref. #4)
7. Align the flat on the inside of the new impeller with the flat on the motor shaft. Push into place, while twisting blades in a clockwise direction.
8. Place new gasket (Ref. #3) on pump body face, align holes and replace cover (Ref. #2).
9. Tighten all four screws evenly and snugly.

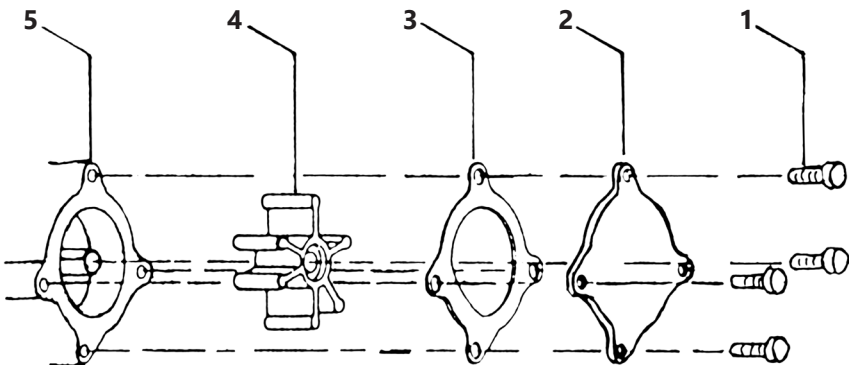



ACCESSORIES

| Item # | Description |
|---------------|---|
| 695-015 | Replacement Pump, HI / LOW Temp, 115VAC 60Hz |
| 695-020 | Impeller Repair Kit for 695-015 Pump |
| 695-000 | Water Transfer Tank 60 Gallon/ Elec. Pump 115Vac/60Hz |



**Water Transfer Tank
60 Gallon/ Elec. Pump
115Vac/60Hz
(Item # 695-000)**

WARRANTY

One year from date of purchase.





The information in this document is subject to change at any time.
Visit our website or contact us directly for the most up-to-date version of this document.

The RPD Logo is a trademark of Radiation Products Design Inc. All product names, company names, logos, and other trademarks are property of their respective owners and are displayed for identification purposes only.